



# CUTLERY DRYER-POLISHER SAM-3001 230/50/1

Tabletop cutlery polishing machine with outlet fan.

P/N 1370043



## FEATURES AND BENEFITS

- ✓ Dries, polishes and removes lime scale stains from cutlery after washing.
- ✓ Fully automatic.
- ✓ Stainless steel body and polishing tank.
- ✓ Rounded cutlery carroussel, avoiding cutlery jams.
- ✓ Economy: saves on personnel costs and quick return of investment.
- ✓ Speed: hourly output of up to 3,000 pieces.
- ✓ Hygiene: the germicidal UVC-ray lamp sterilizes both the cutlery and the polishing product.

## SALES DESCRIPTION

Output: 3000 pieces per hour.

## INCLUDES

- ✓ Germicidal UVC-ray lamp.
- ✓ Drying polishing product 3 kg.
- ✓ Outlet fan.

## ACCESSORIES

- ☐ Polishing product



[www.sammic.co.uk](http://www.sammic.co.uk)

Food Service Equipment Manufacturer

Unit 2, Trevanah Road  
Troon Industrial Park  
LE4 9LS - Leicester

[uksales@sammic.com](mailto:uksales@sammic.com)  
Tel.: +44 0116 246 1900



Project

Date

Item

Qty

Approved

WARE WASHING  
CUTLERY POLISHERS

product sheet  
updated 01/08/2018



# CUTLERY DRYER-POLISHER SAM-3001 230/50/1

Tabletop cutlery polishing machine with outlet fan.



WARE WASHING  
CUTLERY POLISHERS

P/N 1370043

## SPECIFICATIONS

Hourly production (pieces): 3000

Electrical supply: 230 V / 50 Hz / 1 ~ (3 A)

Plug: EU

### Loading

- ✓ Motor power: 175 W
- ✓ Element power: 450 W
- ✓ Uvc lamp power: 8 W
- ✓ Fan power: 50 W

### External dimensions (WxDxH)

- ✓ Width: 489 mm
- ✓ Depth: 652 mm
- ✓ Height: 412 mm

Net weight: 42.3 Kg

### Crated dimensions

515 x 690 x 555 mm

Gross weight: 53.2 Kg.

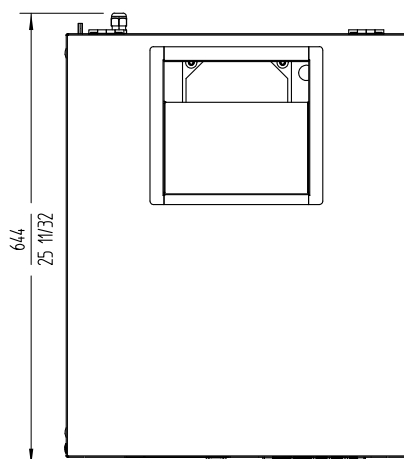
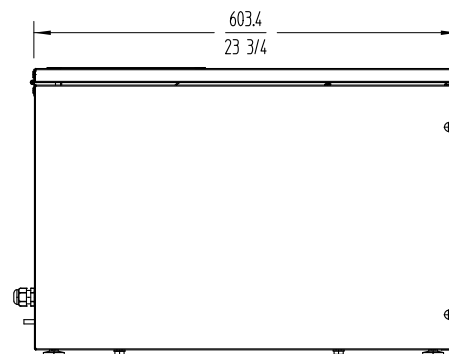
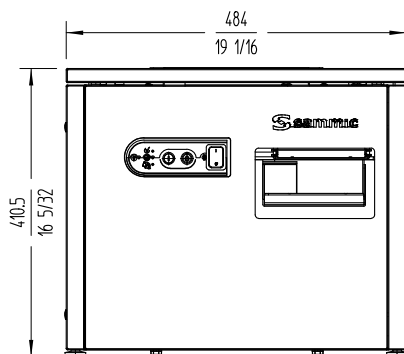

[www.sammic.co.uk](http://www.sammic.co.uk)

Food Service Equipment Manufacturer

Unit 2, Trevanah Road

Troon Industrial Park

LE4 9LS - Leicester

[uksales@sammic.com](mailto:uksales@sammic.com)

Tel.: +44 0116 246 1900



Project

Date

Item

Qty

Approved

product sheet  
updated 01/08/2018